

Finally, as it is the usual custom in architects' offices to prepare drawings with the street frontage (or main entrance) to the bottom of the paper, it may be well asked, Why in the design under consideration this custom has been departed from? But perhaps this is the rule in Australia.

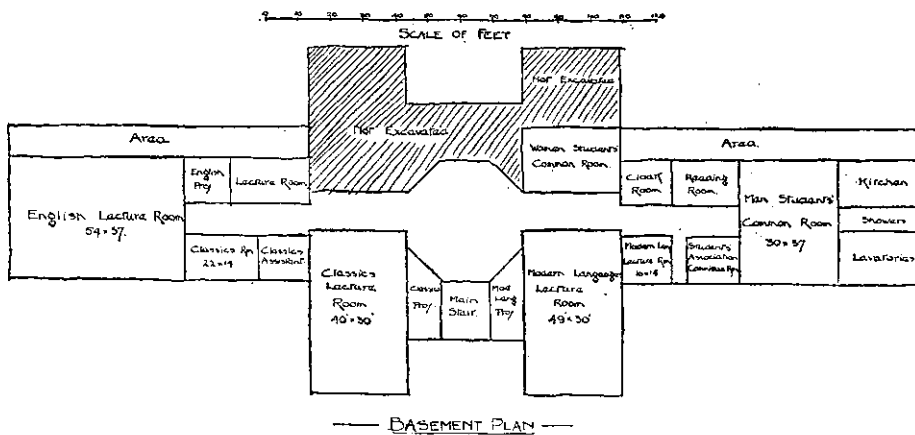
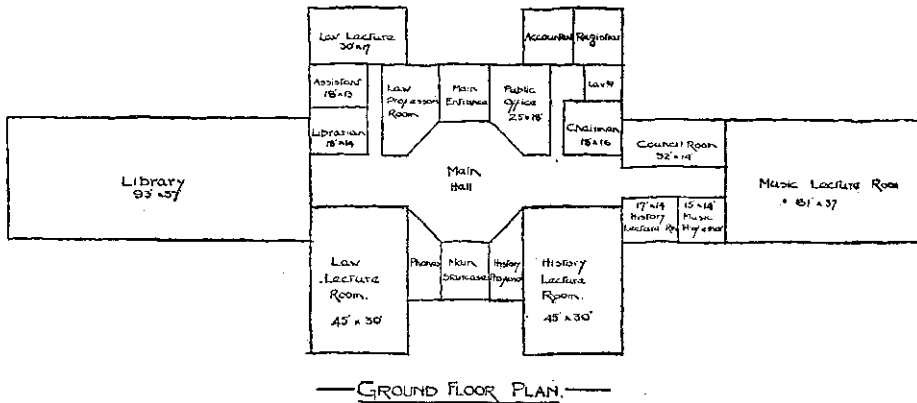
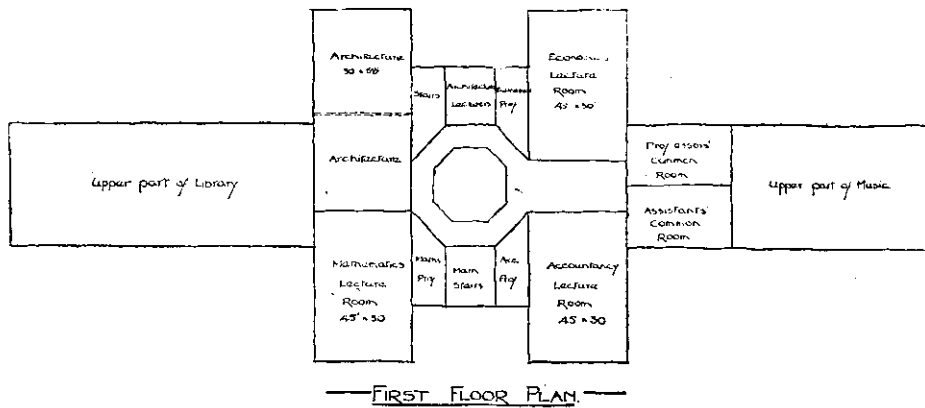

PLAN OF WINNING DESIGN IN THE AUCKLAND ARTS BUILDING COMPETITION.

This rough plan has been made from notes taken while the plans were on view in Auckland recently. It is not necessarily correct in every detail, but is approximately so.