

and balustrade require a pilaster and column treatment half as high again as is shown.

GENERAL EXPRESSION.

Under this heading, meaning the extent to which the designs express the Italian style and the character appertaining to any art gallery, "Italia" is most satisfactory. It was not expected that the competitors would slavishly copy the works of the Italian Renaissance but that they should adopt the principles underlying the use of architectural motifs which gave a particular character to the works of that period, to express modern knowledge of art gallery

this competition should be encouraged to work, and work hard, to master the historic forms of architectural construction and design and to learn architectural drawing, not by trying merely to make pretty patterns on the paper but by realising the form that is to be expressed. To this end much charcoal should be used for small scale as well as large scale studies. Shadows are sometimes not required in finished drawings, but in process of studying a problem they should be some of the earliest lines on the paper. They may tell some unpleasant truths, but they never lie.

W. H. GUMMER.

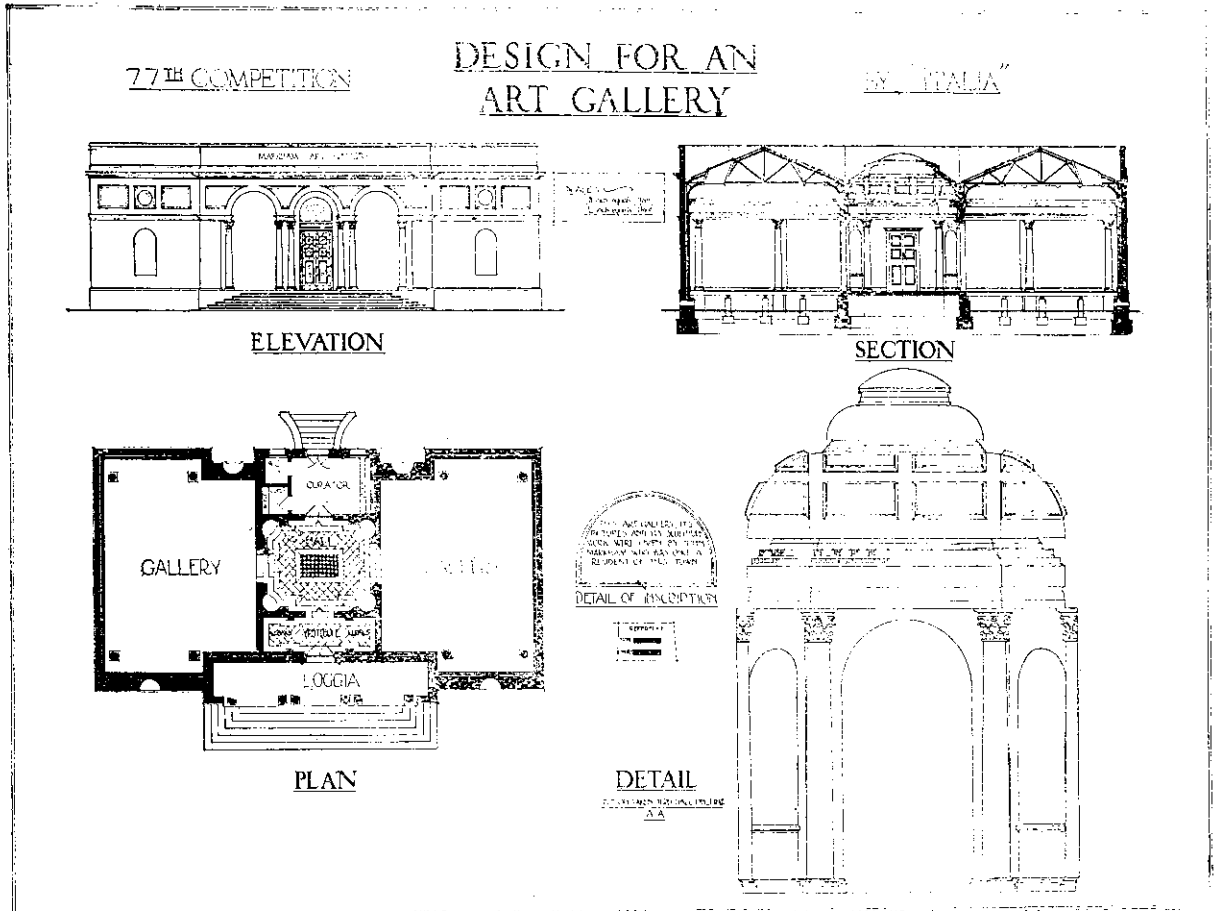

Design "Italia", by Edgar Miller (with Messrs. Ford & Talboys, of Wanganui), placed second in our 77th Competition.

planning and construction. This requirement of the programme has been very broadly interpreted by some of the competitors whose designs are reminiscent more of American and English classic architecture than of Italy.

Another requirement of the programme was a brief inscription indicating the origin of the gallery. This opportunity "Palladio" has appreciated best in the words suitably worked in a panel over the entrance:—"For love of Truth and Beauty John Markham gave this Gallery for the pleasure and inspiration of his fellow-townsmen." Thus is recorded simply and effectively the donor, and the purpose of the gift.

The assessor feels the limitation of pen and paper in these criticisms, but his desire is to be as helpful as possible to the student. The facility for design should be comprehensive: no student should be satisfied with a good elevation and a poor plan or vice versa. The ability to design is not gained in a short time, but the students in

"As a citizen of Christchurch and of New Zealand, I hope that there will never be standardised houses in this Dominion," said Mr. W. H. Winsor at a recent meeting of the North Canterbury Unemployment Committee. "As old Shakespeare said, 'Variety is the spice of life,' and I think it will be better for all if no standardised design is adopted."

In addition to the 10 houses at Northcote Road, Auckland, completed under the Labour Department's housing scheme, there are at present twenty-four in different stages of erection, some just having been started, and others nearing completion.