

Railway Department's Housing Schemes.

Interesting Developments at Marton and Frankton Junctions.

Through the courtesy of the General Manager of Railways and the Department's architect, we are able to reproduce some plans and elevations of houses the Department is building for the railway employees, together with some lay-outs of schemes for housing at some of the important railway junctions.

ous work is ensured for the men. The first house is quickly roofed over in fine weather, and the framing of the others gone on with in fine weather. When it comes on wet the men are employed inside. The scheme has been in operation seven months, during which time no man has lost a day's work.

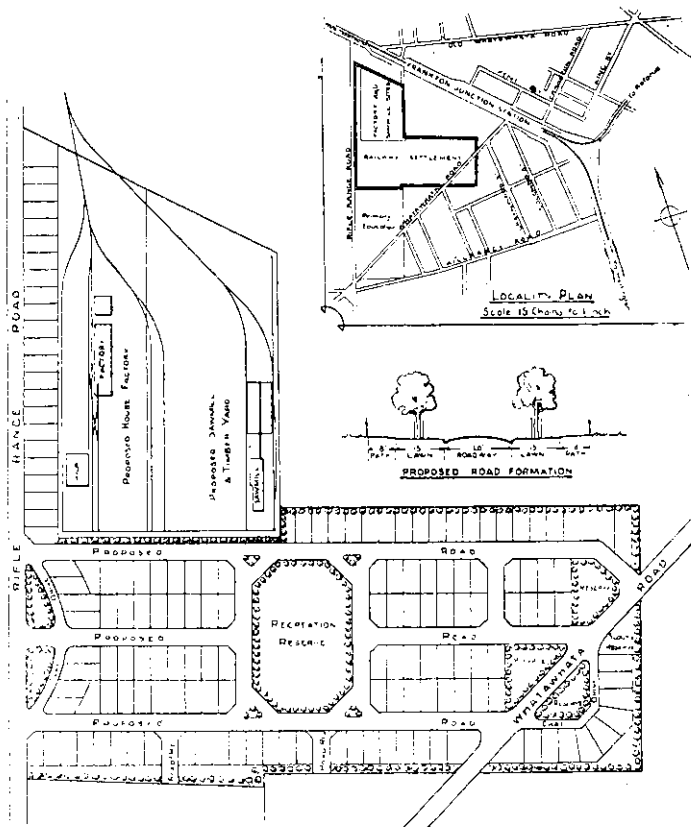

RAILWAY DEPARTMENT'S SETTLEMENT AT FRANKTON JUNCTION

The total area of the site is 80 acres, of which 50 acres are reserved for the proposed house factory and timber yard. We direct attention to the section of the proposed roads, showing an improvement on the usual practice of providing a wide expensive dusty stretch of Macadam.

THE MARTON JUNCTION SCHEME.

An area of 48½ acres has been set aside at Marton Junction adjoining the railway station, and laid out on town-planning lines for the Department's new housing scheme for its employees. It is expected that some 50 houses will be erected here, and a start has already been made by the erection of the first ten houses.

The Department is letting in separate contracts carpentering, joinery, brickwork, plumbing, painting, and any other work required, each contractor undertaking a number of houses. By doing this continu-

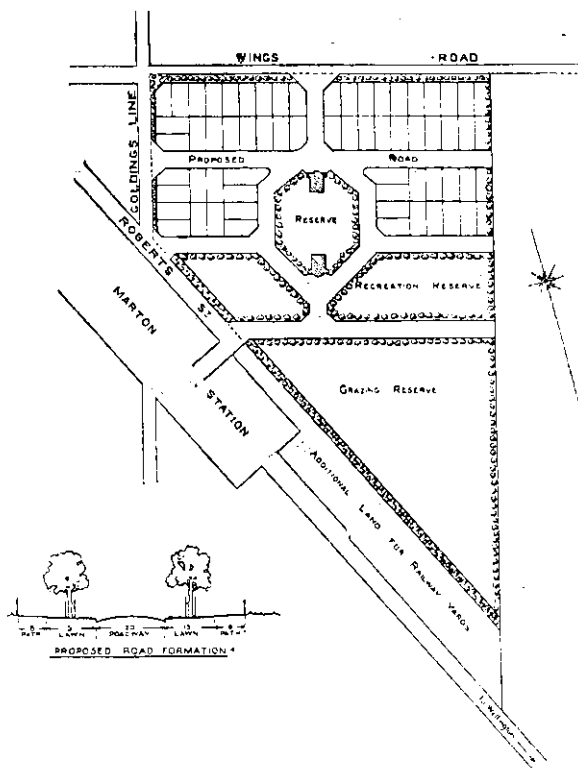

RAILWAY DEPARTMENT'S SETTLEMENT AT MARTON JUNCTION.

There are sixty sections for dwellings, and at least one-third of the whole area is set apart as public reserves.

The contracts are for the whole of the labour and such material as can easily be obtained by the contractor, the Department undertaking to supply all materials which are difficult to procure. The timber is supplied from the Department's own sawmill at Mamaku, and Departmental contracts have been arranged for the other supplies. For the 85 houses at present under construction in various places none of the contractors has been kept waiting for any material whatever. It is in the interest of the contractor to use every expedient in completing his contract, and the result of the system has been that the Department is building houses at a much quicker