

Block of three Cottages—Front Elevation.

formed connecting the Circular Avenue with Hounslow road. Access to the houses on the S.E. bank of the river will be by means of a small foot-bridge placed centrally along the new road and giving on to a small green, around which the houses will be grouped.

The shopping centre will be on the N.E. side of Hanworth road, immediately at the entrance to the suburb.

A fine mansion and its beautiful gardens, situated in the centre of the Central Park, will be available for the use of the tenants. The usual amenities of

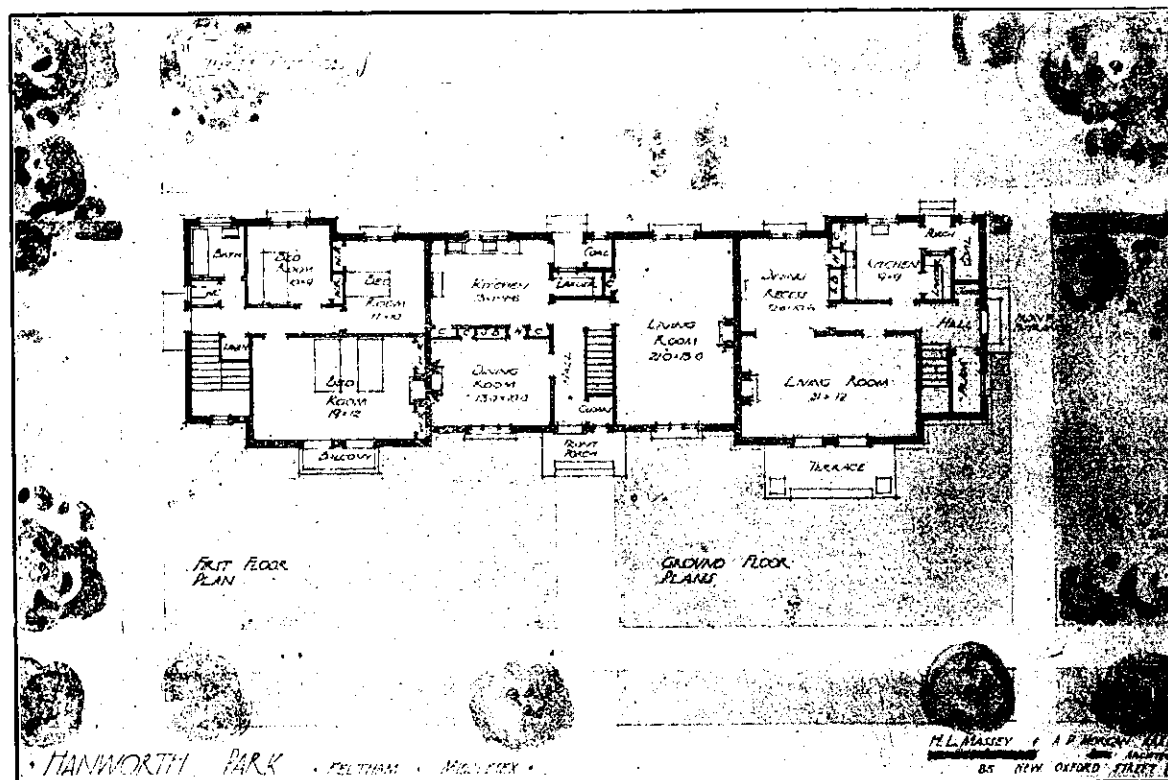

Block of three Cottages—Plan of Ground Floor.