

that hundreds may come from the factory on one order and missing parts be easily replaced. The profusely timbered doorway is made to their measure. Outside this front door you may find a perforated sheet of metal, to serve for a doormat or scraper. Inside, a flight of from twelve to thirty-six stairs leads down at an easy angle. The treads of the stairs and the descending roof of the staircase are formed of mining frames of stout timber, with double top sills; the walls are of thick planks notched at the top and bottom to fit the frames, and strengthened with iron tie-rods running from top

section of a platoon had its allotted places for messing and sleeping, its own place for parade in a passage, and its own emergency exit to the trench. In another, used as a dressing station, there are beds for thirty-two patients and a fair-sized operating room. A third, near Mametz, was designed to house a whole company of 300 men, with the needful kitchens, provision and munition storerooms, a well, a forge riveted with sheets of cast iron, an engine-room, and a motor-room; many of the captured dug-outs were thus lighted by electricity. In the officers' quarters there have been found full-length mirrors,

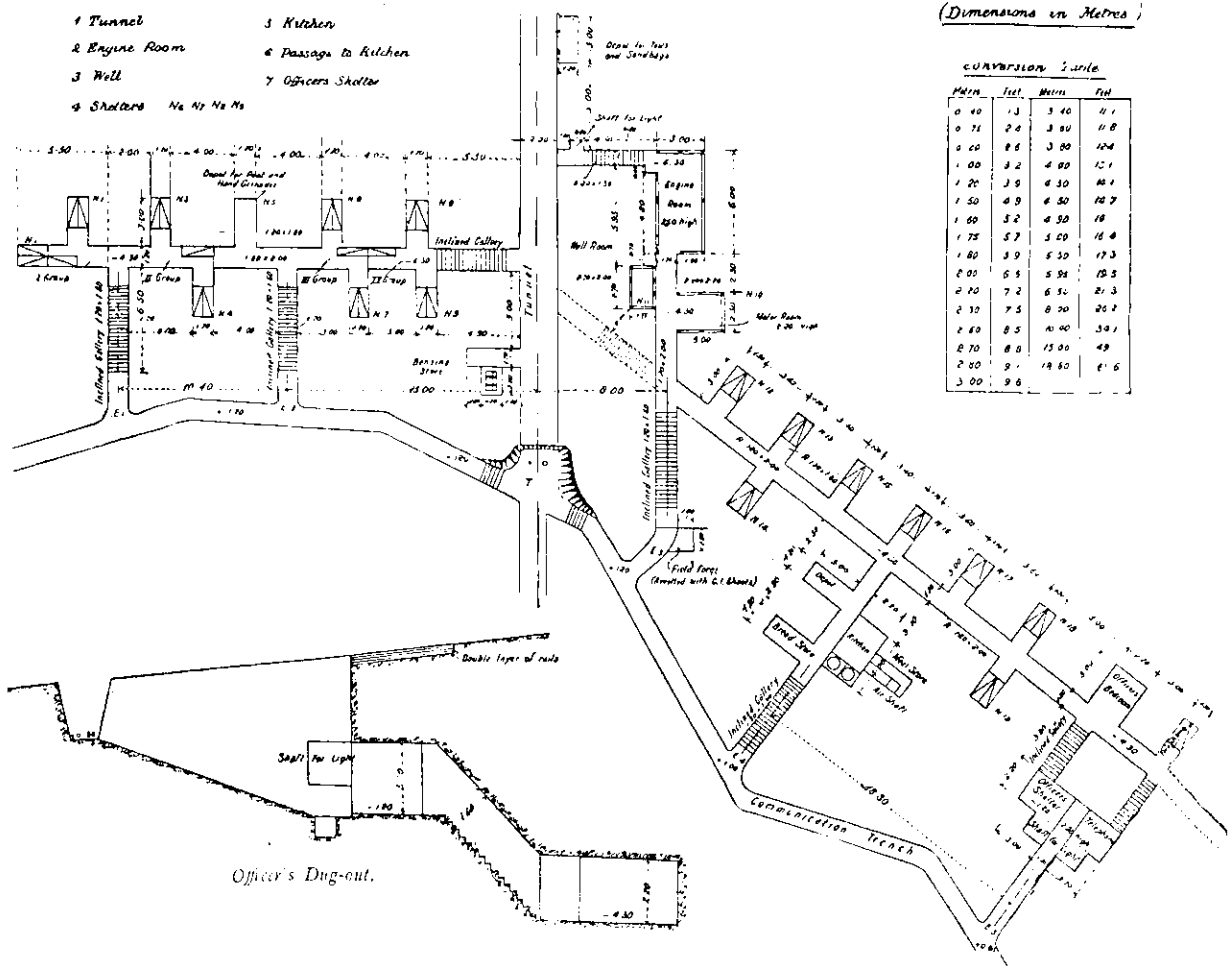

Plan of German Dug-out near Mametz, accommodating 300 men.

to bottom of the stairs and with thick wooden struts at right angles to these. At the foot of the stairs a tunnelled corridor runs straight forward for anything up to fifty yards, and out of this open rooms and minor passages on each side. In many dug-outs a second staircase, or two staircases, lead to a lower floor, which may be 30 feet or 40 feet below the trench level.

All these staircases, passages, and rooms are, in the best specimens, completely lined with wood, and as fully strengthened with it as the entrance staircase already described. In one typical dug-out each

comfortable bedsteads, cushioned armchairs, and some pictures, and one room is lined with glazed "sanitary" wallpaper.

Other German trench works show the same lavish use of labour as the dug-outs. In the old German front trench south of La Boisselle an entrance like that of a dug-out leads to a flight of twenty-four stairs, all well finished. At their foot a landing 3 feet square opens on its farther side upon a nearly vertical shaft. Descending this by a ladder of thirty-two rungs you find a second landing like the first, opening on a continuation of the shaft. Down