

and is electrically lighted throughout. It is a one-storeyed building, in a splendidly sunny position. Along almost the whole front runs a deep and sheltered verandah, which can be fully protected from the wind by sliding glass screens and folding doors if necessary. At each end are spacious wards for the children, each being capable of holding about 30 beds without crowding. The wards are furnished in first-rate style, and the rows of neat little iron beds and cots, with their spotless white counterpanes look very well indeed. Besides the children's wards are bedrooms for the sisters, a large playroom in which dolls' houses are a prominent feature, a sitting room for the sisters, a home-work room, splendidly-fitted-up bathrooms, and every opportunity has been taken to use up available space with cupboards, pantries, and other useful conveniences for rendering the working of the wing easy.

Mr. Righton at the dedication ceremony said that they had secured land for a boy's home at Timaru. The combined homes when furnished would cost about £30,000.

The Crystal Palace Limited are about to erect what they term the most up-to-date theatre in Christchurch, which is to be "a distinct advance on any picture theatre in New Zealand at present" according to the Manager of the Company. The site gives access to the theatre from two directions, viz.:—Gloucester Street and Cathedral Square. On the mezzanine floor will be an electrical fountain, palm alcoves, promenade, retiring rooms, and lounge. The company intends building similar theatres in the other main centres.

#### DUNEDIN.

The number of permits issued from June 16th to July 17th, was 31, representing £12,006 in value. The business premises included N.Z. Government Telephone Exchange Offices at South Dunedin. Branch Station for Dunedin Fire Board at South Dunedin. 6 brick buildings. 8 wooden buildings. 17 additions and alterations.

Messrs. J. Barton & Son, Architects have let contracts for a five-roomed residence in Oxford Street and two seaside residences at Warrington each of five rooms with large verandah.

Mr. E. W. Walden, Architect has in hand the following work:—Extensive additions to Messrs Donaghy & Co's. rope factory in South Dunedin; Contractor Mr. J. S. White. Shops with offices above are being erected in George Street in connection with Lang's estate; the shop fronts will be completed in oak; the stall boards, piers, and ingoings to be tiled. A five-roomed brick residence has just been completed in Campbell Street; contractor W. H. Mills. The same contractor has lately completed another five-roomed wooden residence in Eglinton Road for Mr. R. Walden. The Metropole private hotel, St. Clair is undergoing extensive additions and is being renovated inside and out, the balcony is to be replaced and extended. When this work is completed the building will contain some 30 rooms. The work is being carried out by Messrs Robson & Crawford, contractors.

Mr. Leslie D. Coombs, A.R.I.B.A., has in hand additions to the Oban hotel, Stuart Street, Messrs Wood & McCormack, contractors. Alterations and improvements have lately been made to the arrangement of the offices and to the front of the Waitaki Dairy Company's building in Castle Street, Messrs. Robert & Co., contractors. Messrs. Shank & Fountain's tender

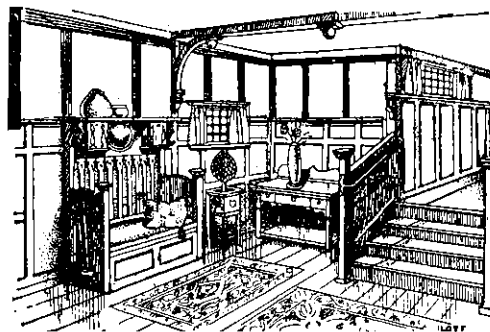

AMIWUD Panelling is durable, economical and beautiful, moth and vermin proof—the ideal interior decoration. It is obtainable both in plain and hardwood finish—takes the place of scrim and paper—makes excellent dadoes and friezes for plastered walls.

## Amiwud

### PANELLING

can be used in many ways—for ceilings, walls or skirtings. Write for the beautifully illustrated Amiwud Booklet—it is free!

## Aubrey Gualter & Co.

WELLINGTON.

17

# PATENTS

## Obtained in all Countries!

Genius is a Quicker Road to Wealth than Hard Work  
Ideas in the shape of inventions are coinable into £ s. d.  
The progress of the world is due to its inventors  
Heads earn more than Hands

# Baldwin & Rayward

## Engineers and Patent Experts

#### OFFICES:

DUNEDIN..... Joel's Building, Crawford Street  
CHRISTCHURCH..... Corner of High and Cashel Sts.  
INVER ARGILL..... Esk Street  
AUCKLAND..... 8 Smeaton's Buildings  
NEW PLYMOUTH..... Walter Bewley, Representative  
WANGANUI..... J. L. Stevenson, Representative  
NAPIER..... Cranby & Co., Representatives  
HASTINGS..... J. A. Fraser, Representative  
NELSON..... G. Langley Bell, Representative  
BLLENHEIM..... W. T. Churchward, Representative  
PALMERSTON NORTH, Ravenhill & Co., Representatives

#### Head Office:

215 Lambton Quay, Wellington

Telephone: 2693

**Edward D. McLaren,**  
Quantity Surveyor and Valuator

221 Victoria Arcade  
Auckland

Telephone No. 2499

**Hugh C. Grierson,**  
Architect

Security Buildings,  
Queen Street, Auckland